

SSV Normandy Quick and Dirty Assembly Instructions

The SSV Normandy is a spaceship from the game Mass Effect. This paper model kit was developed by [Steve Bondy](http://stevebondy.ca) (<http://stevebondy.ca>) and is based on a 3D model by [yopyop](http://ngmods.com) of ngmods.com, and found at bridgecommander.filefront.com. This paper model kit was developed very quickly in response to a special request and represents a straight conversion of the original 3D model to paper model form. From the pictures I've found on the internet the 3D model is not totally accurate (the fuselage seems shorter and thicker, certain details are omitted, etc), but no attempt has been made to correct these inaccuracies. Perhaps I will release a future version that addresses some of them.

In the meantime, enjoy building the model, and if you have any questions or comments I'd love to hear from you, and if you build it, I would love to see a picture of your finished model.

Main Fuselage

Begin by assembling the front and rear sections of the main hull.

Part 1 is inserted into the front of the ship as shown here:

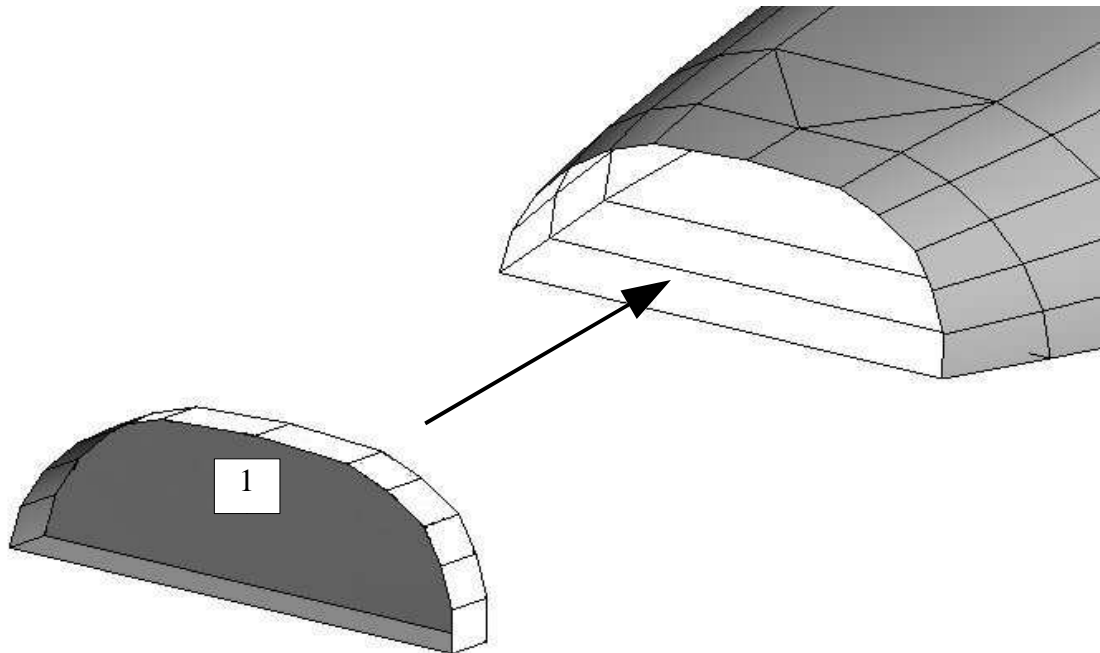

Once the front and rear sections are complete the middle section can be assembled around these, using it to join the two sections together.

Working on a firm, flat surface, join the bottom of the middle section to the bottom of the front section. Next, join the bottom of the middle section to the bottom of the rear section.

Now, continue “wrapping” the middle section around the other two sections, joining it to both simultaneously as illustrated below. I recommend cutting off the tabs and using joining strips instead. This will give a smoother hull.

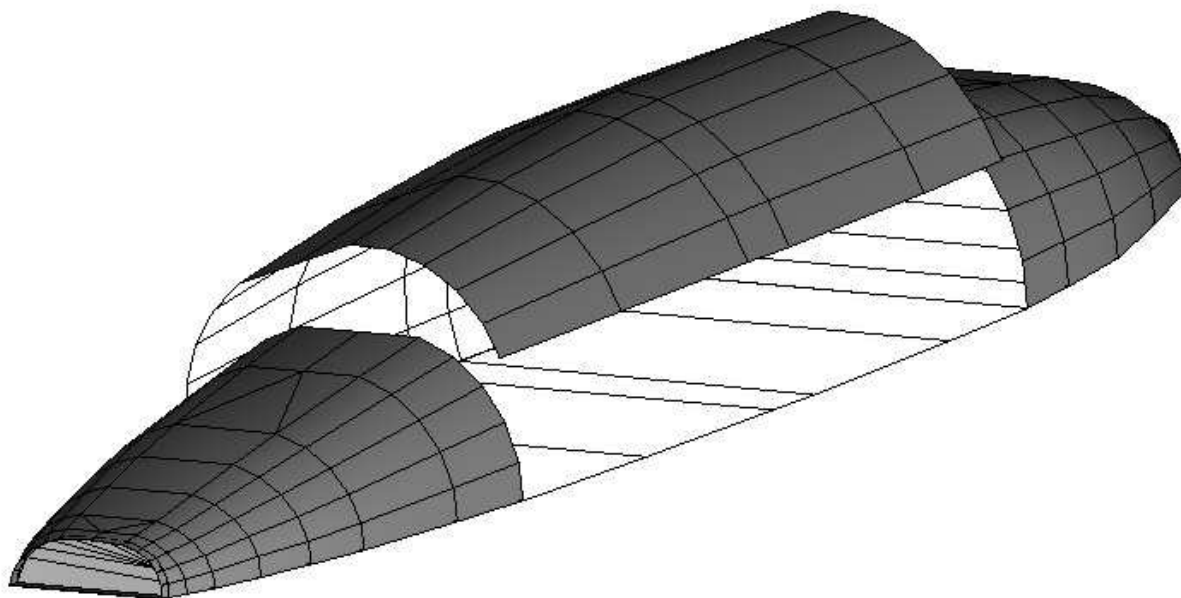

Details of the tail assembly are shown on the parts sheets. The placement of the “pointy things” on the front is shown below. They should be flush with the outer edge of the hull.

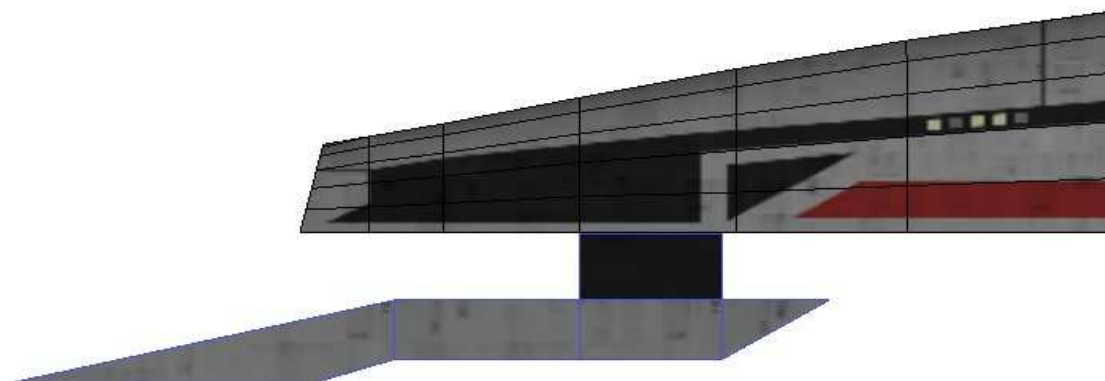

Lower Hull

Assembly of the lower hull should be fairly obvious. The small gray part is folded and inserted as illustrated below.

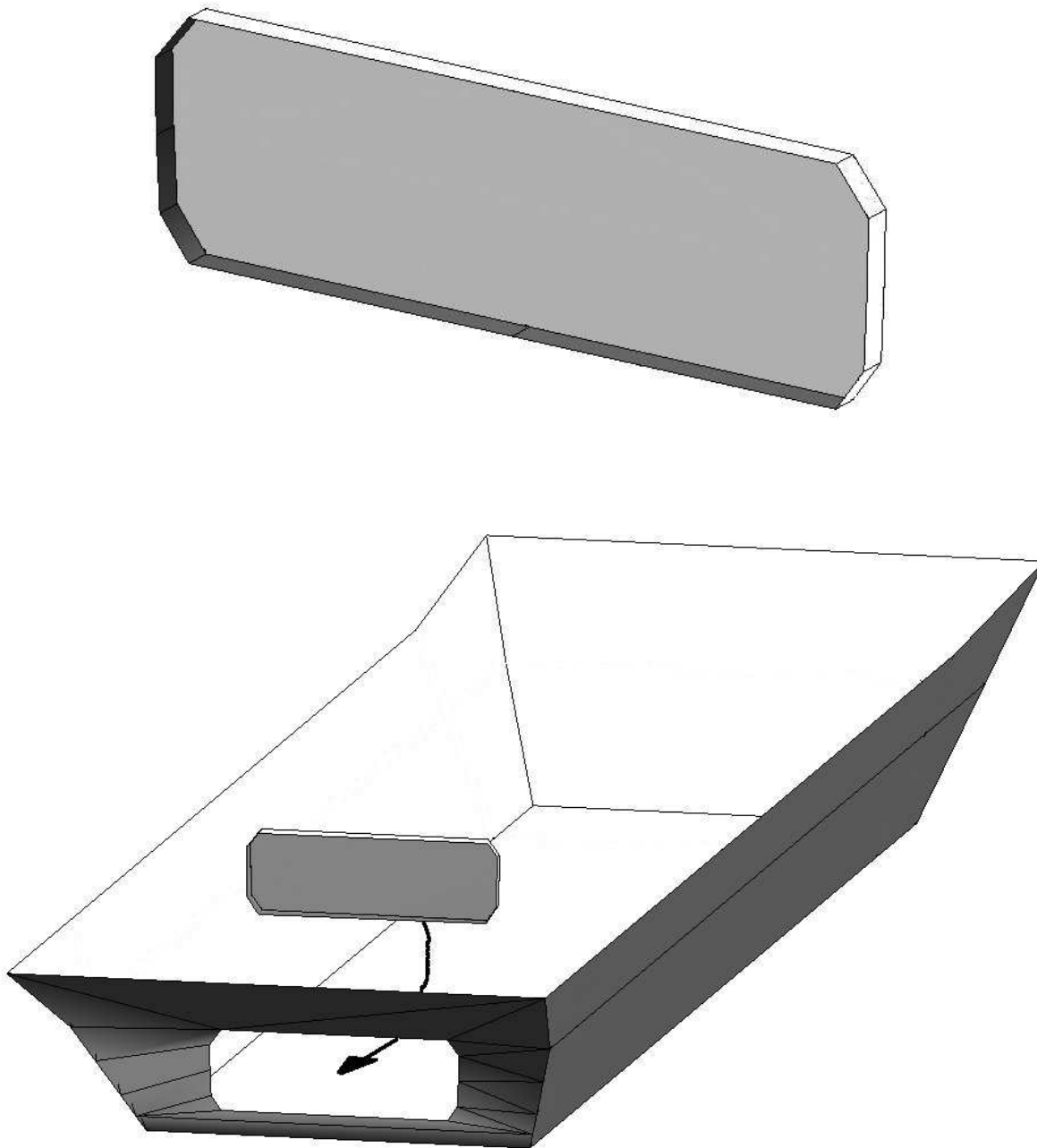

When the lower hull is complete, attach it to the upper hull

Side View

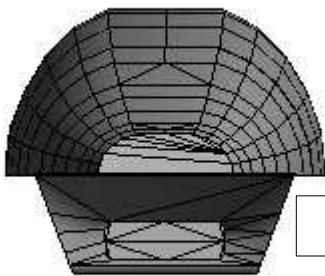
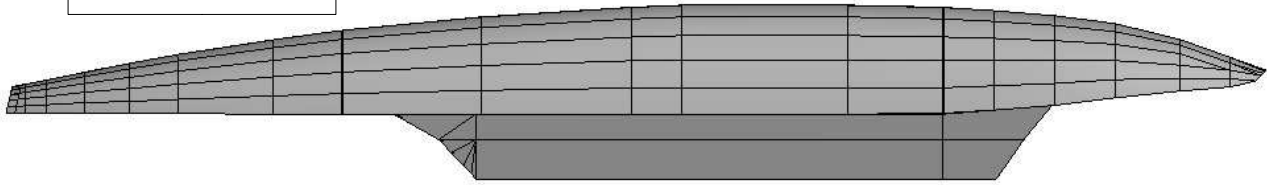

Front View

Lower Wing/Engine Assembly

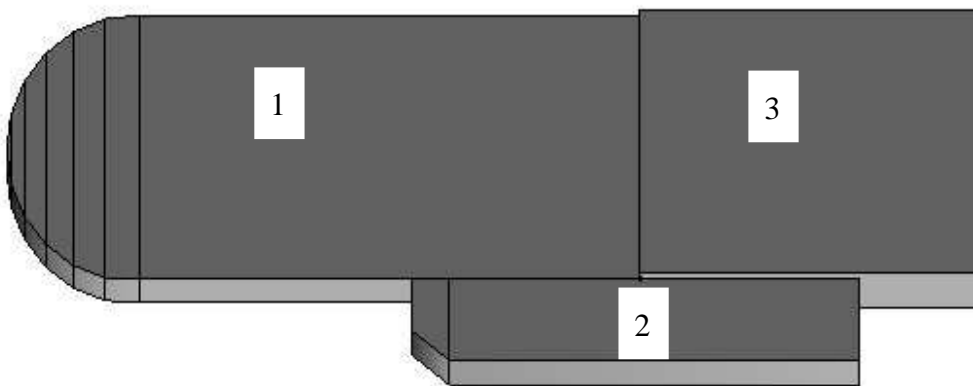

Side View

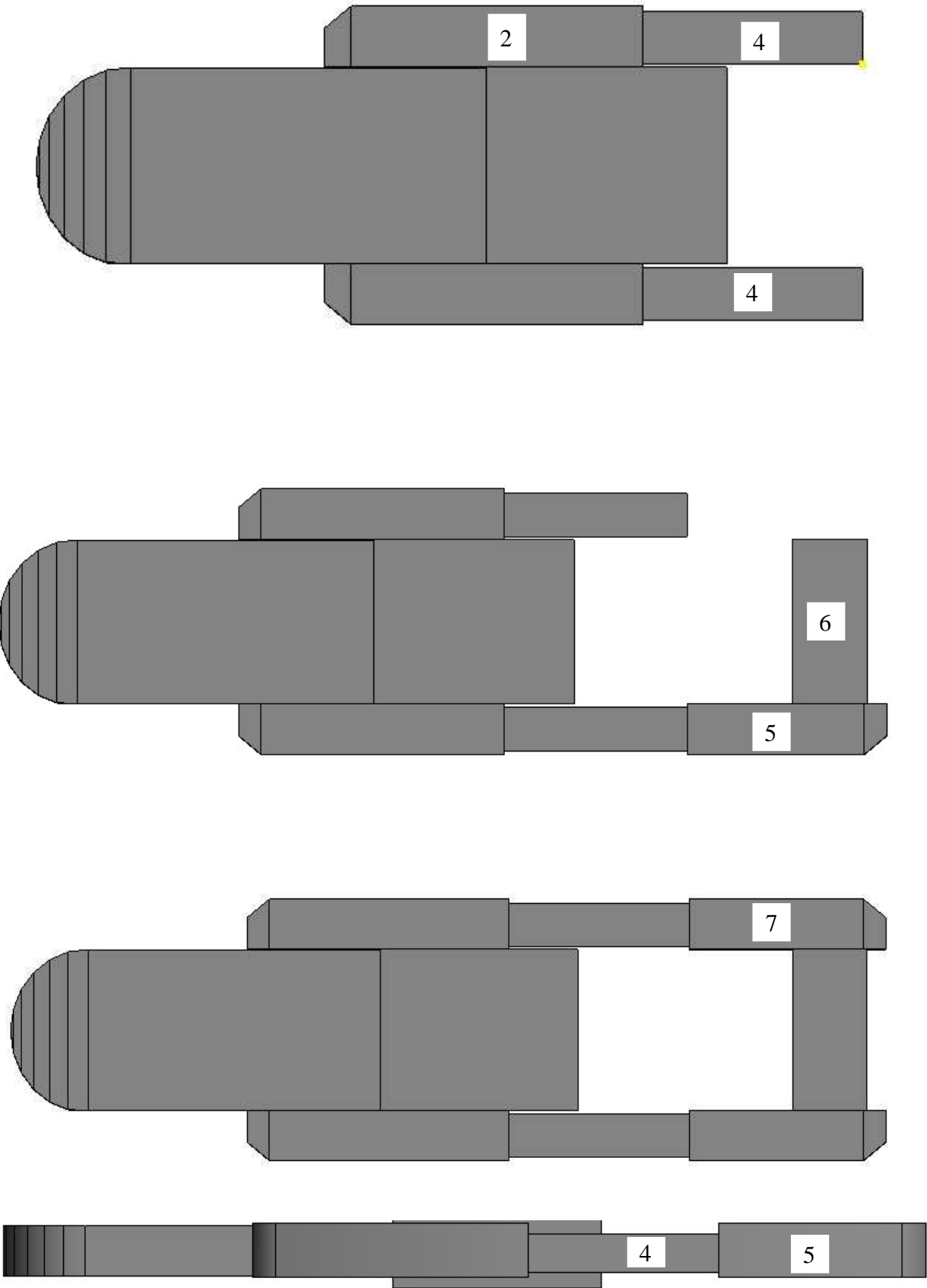

Side View

Rear View

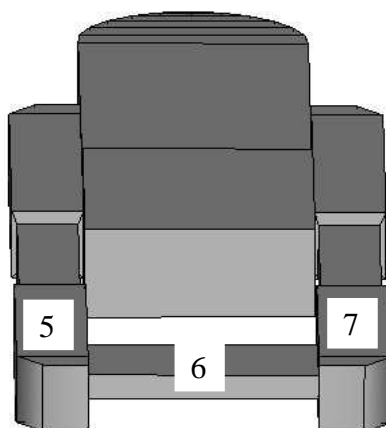

Finally, fold and assemble the wing arm, attach the engine, and attach the arm to the Lower hull.

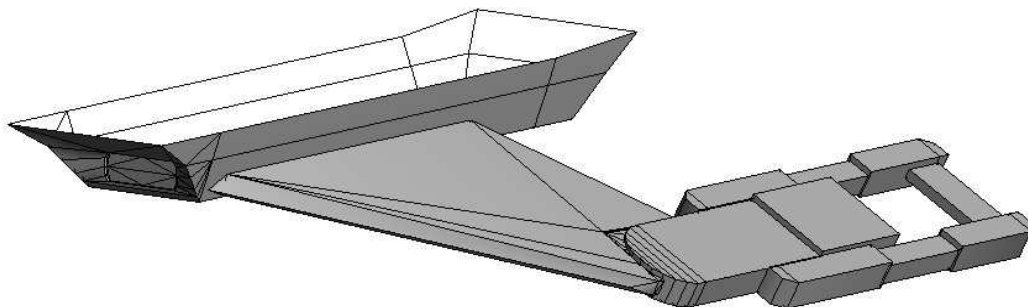
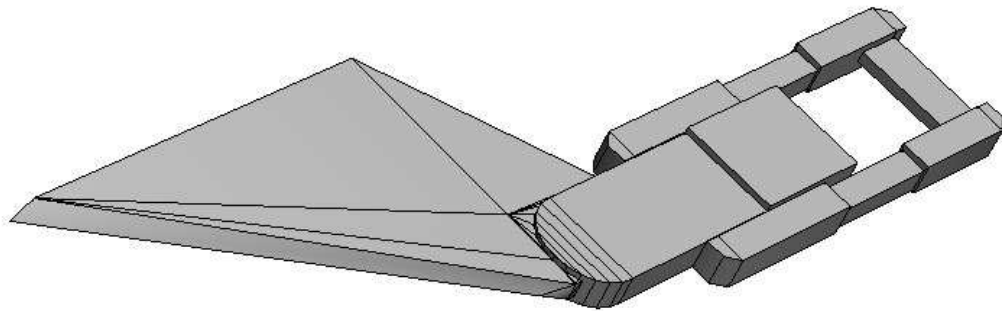
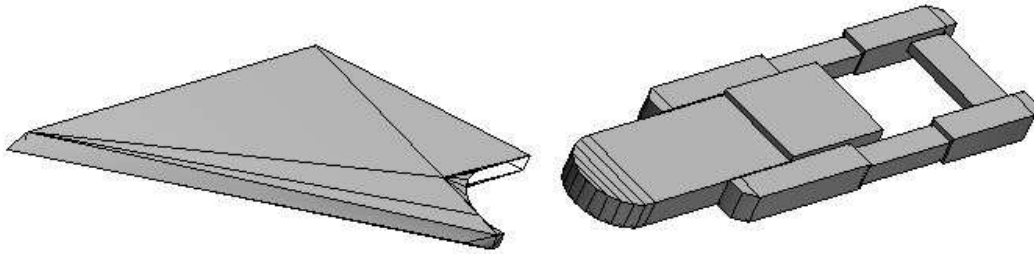

Upper Wing/Engine Assembly

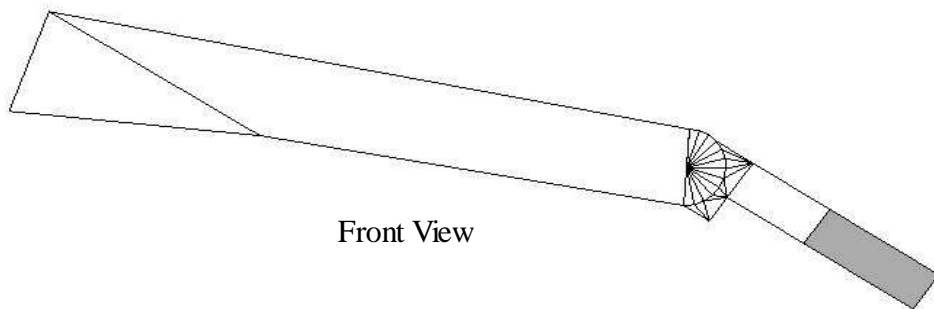
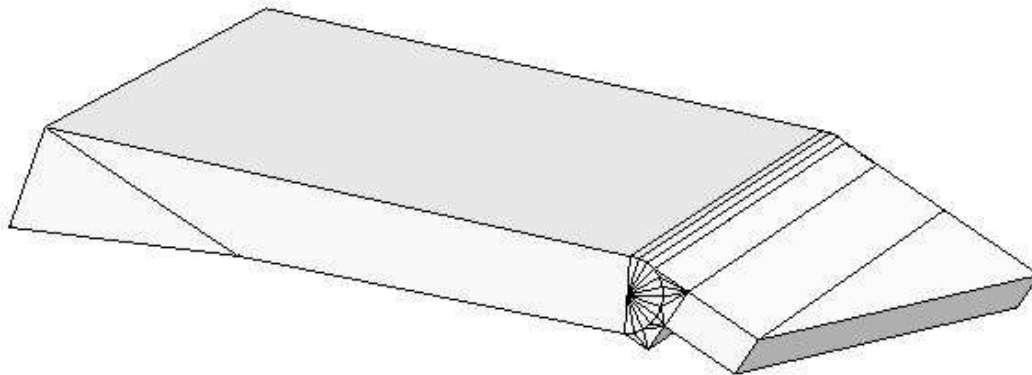
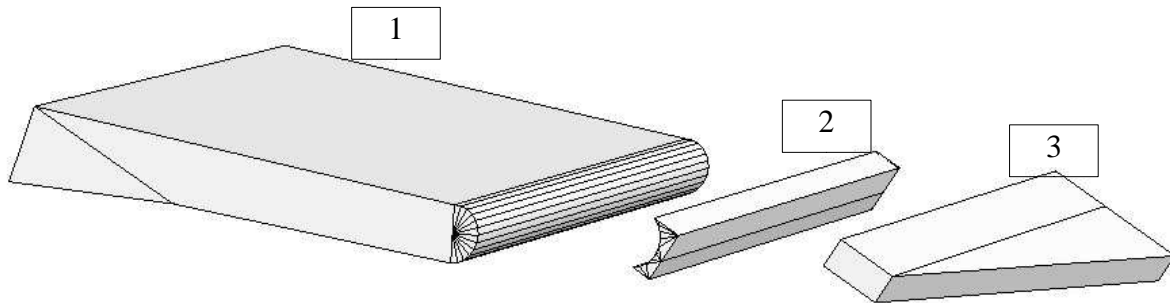

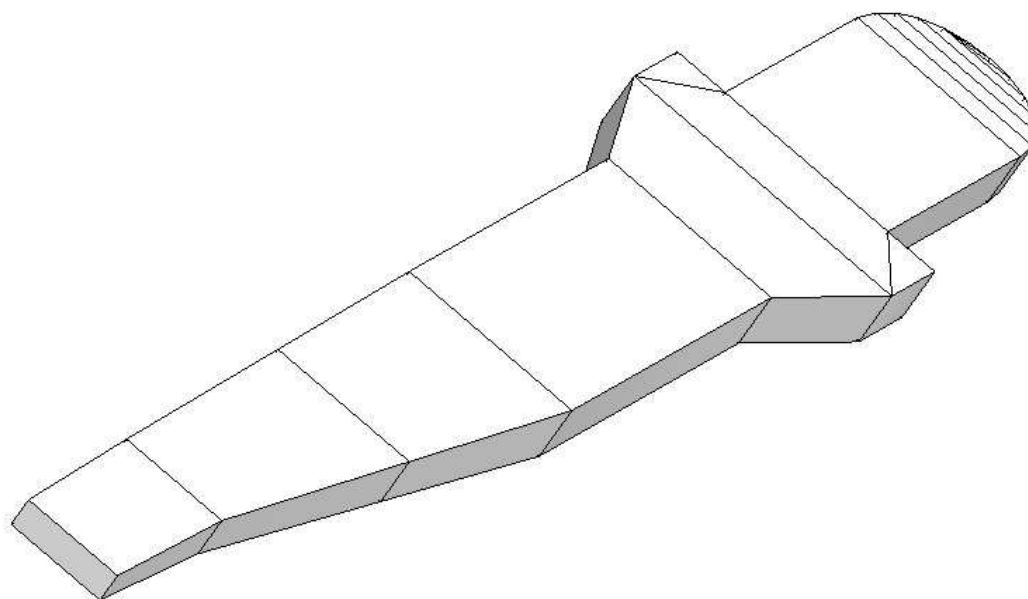
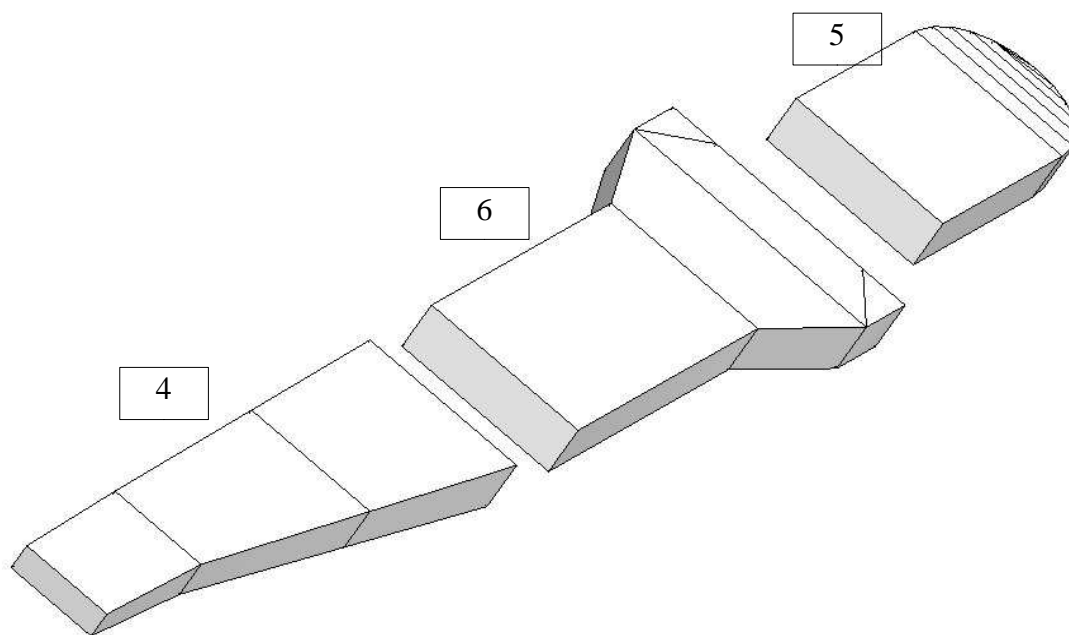

Note that parts 9 and 10 are different shapes, and note their positions.

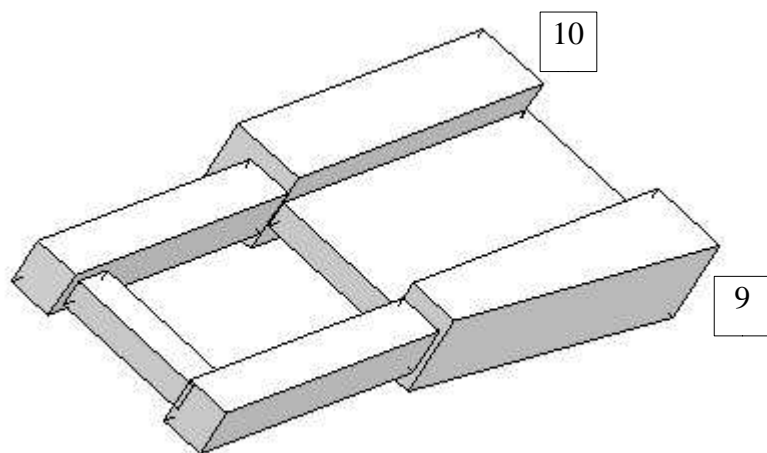
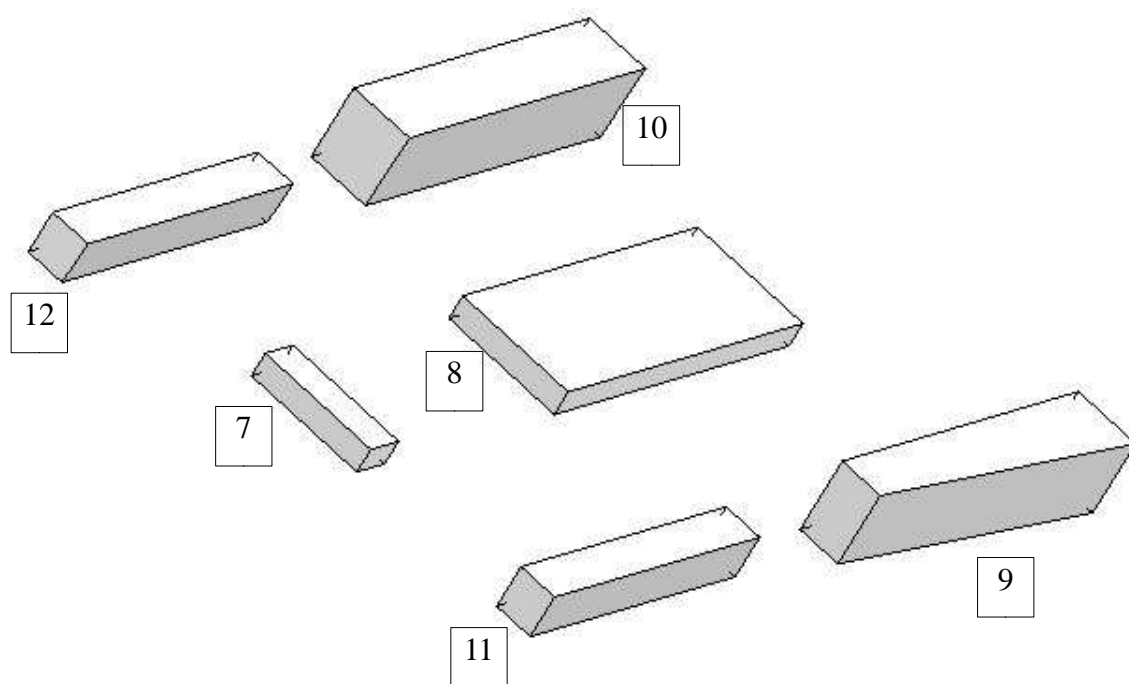

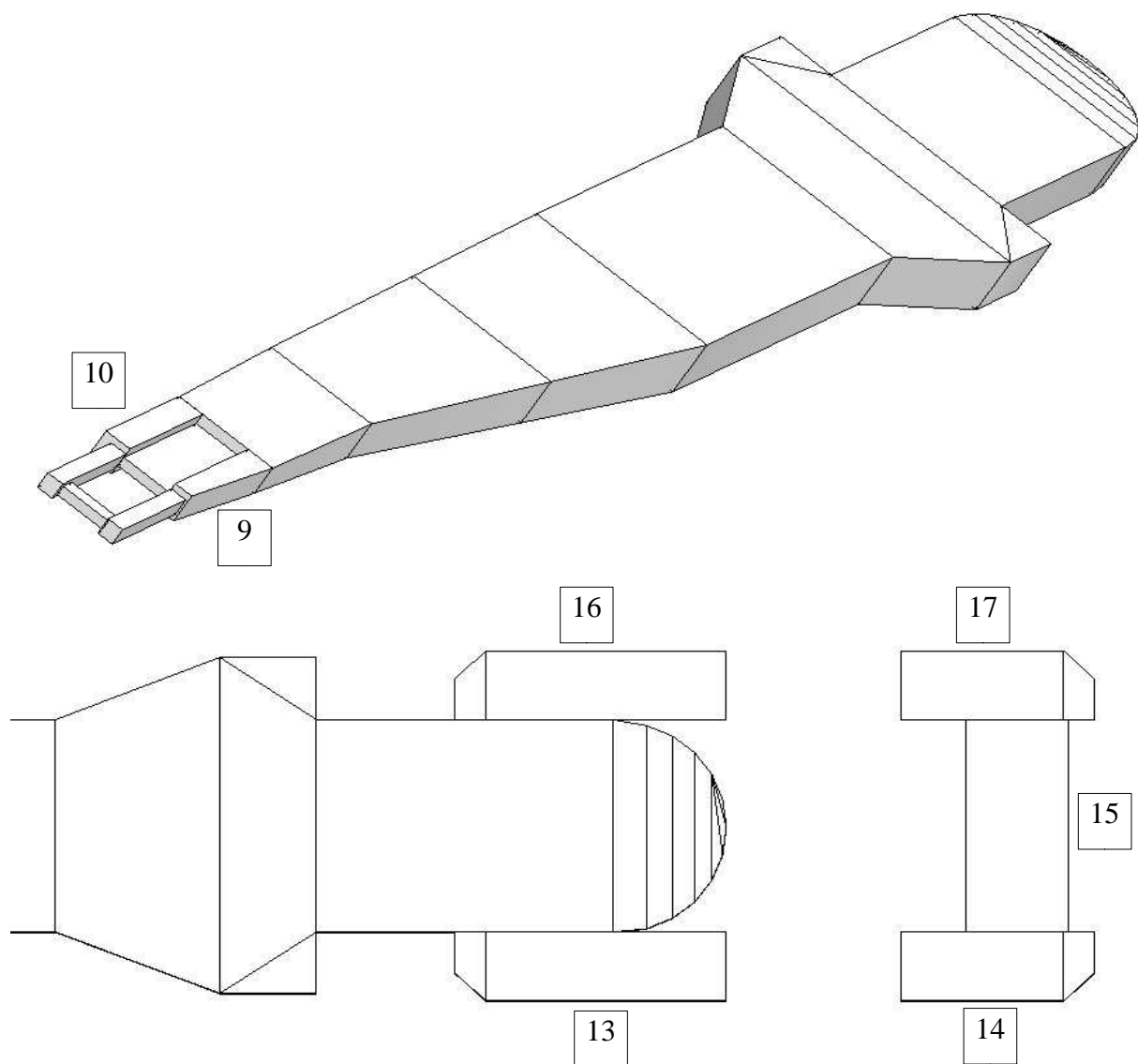

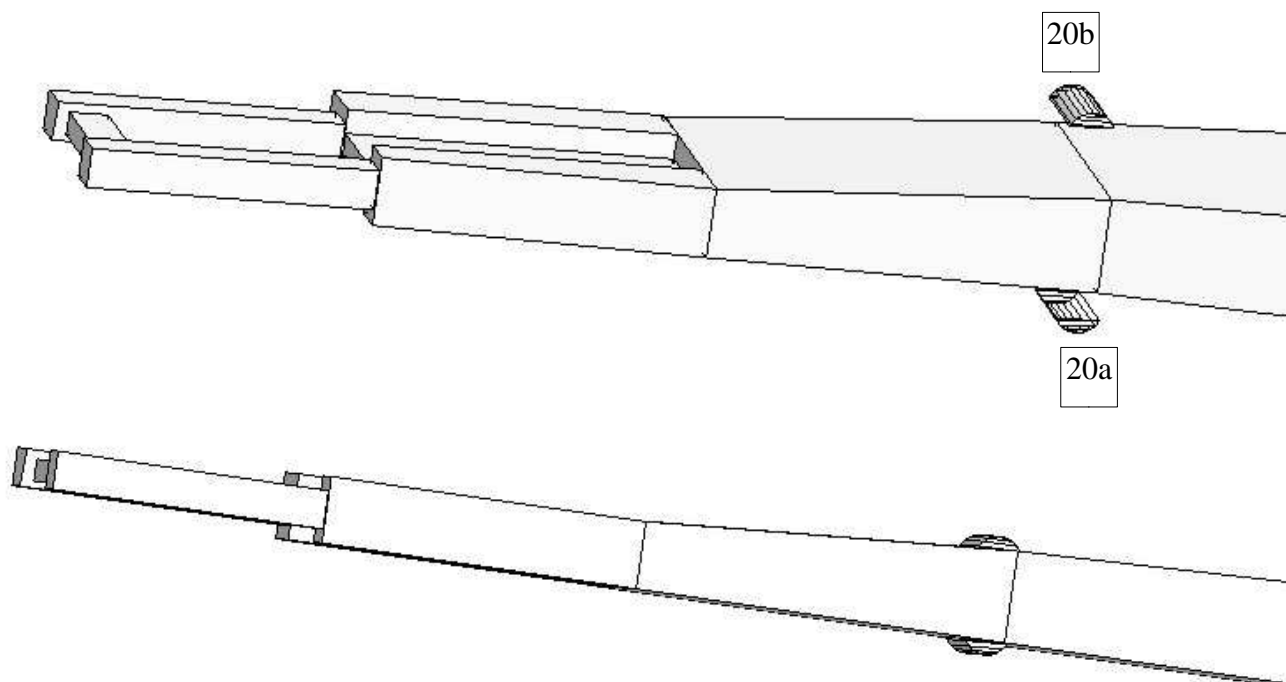
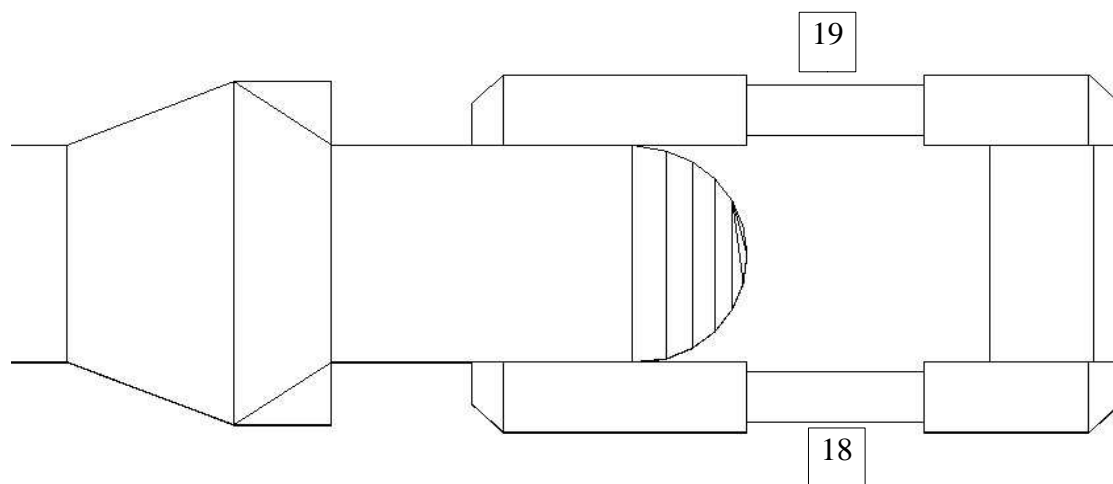

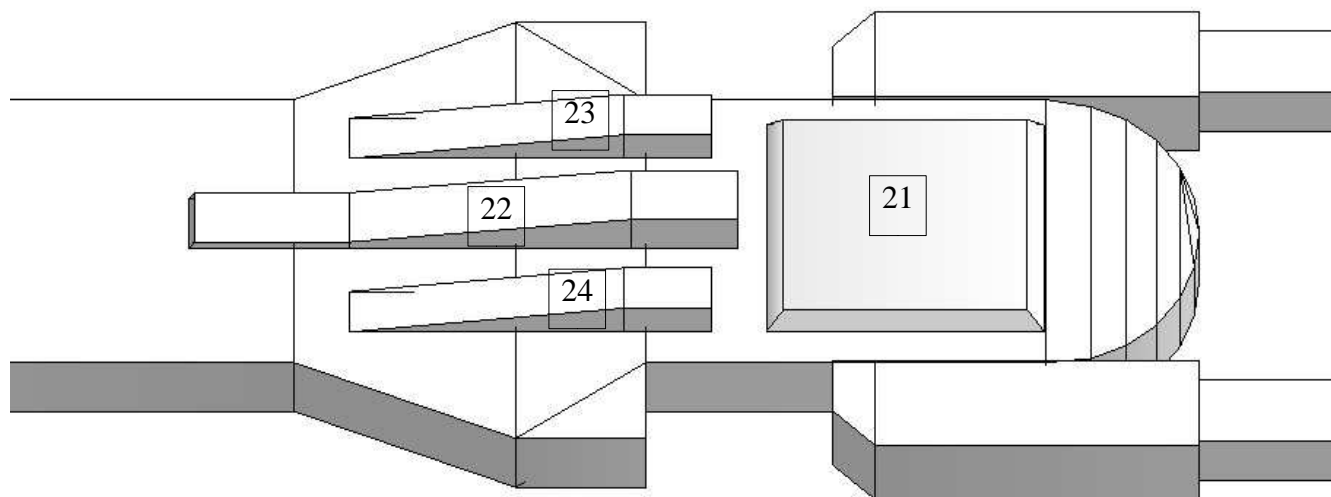

Study the following images for placement of the mounting arm and attachment to lower hull

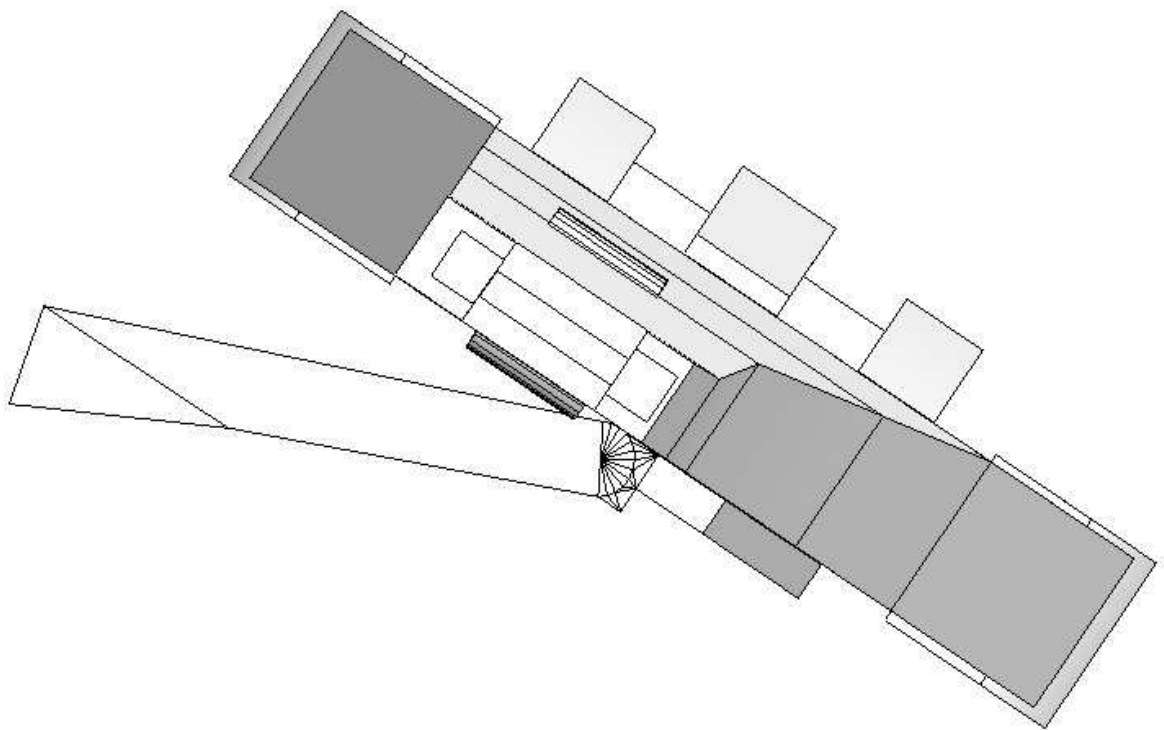
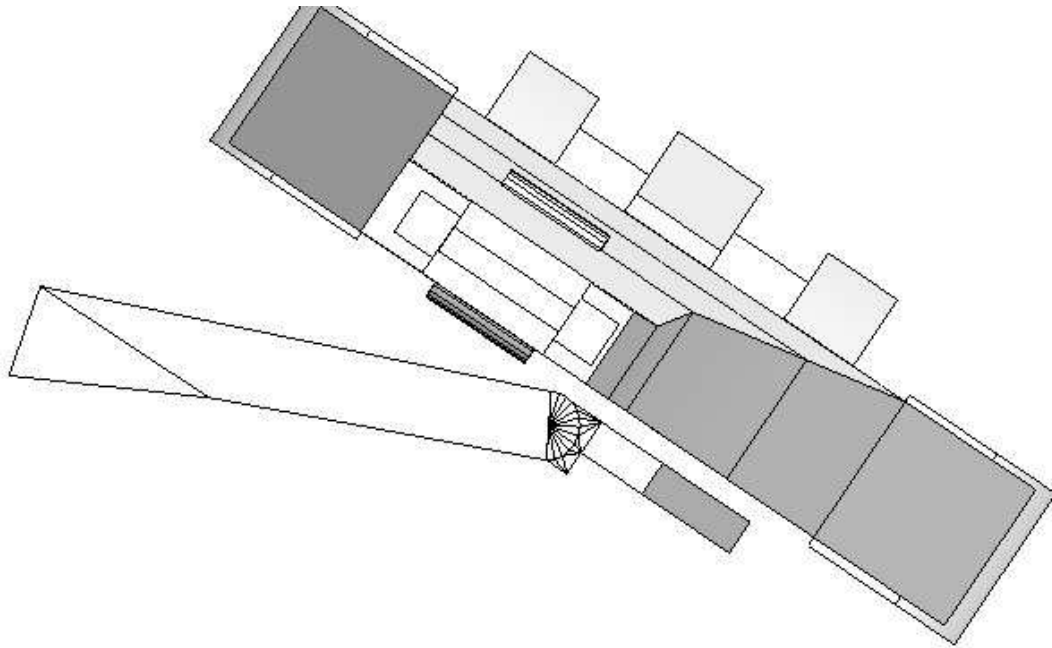

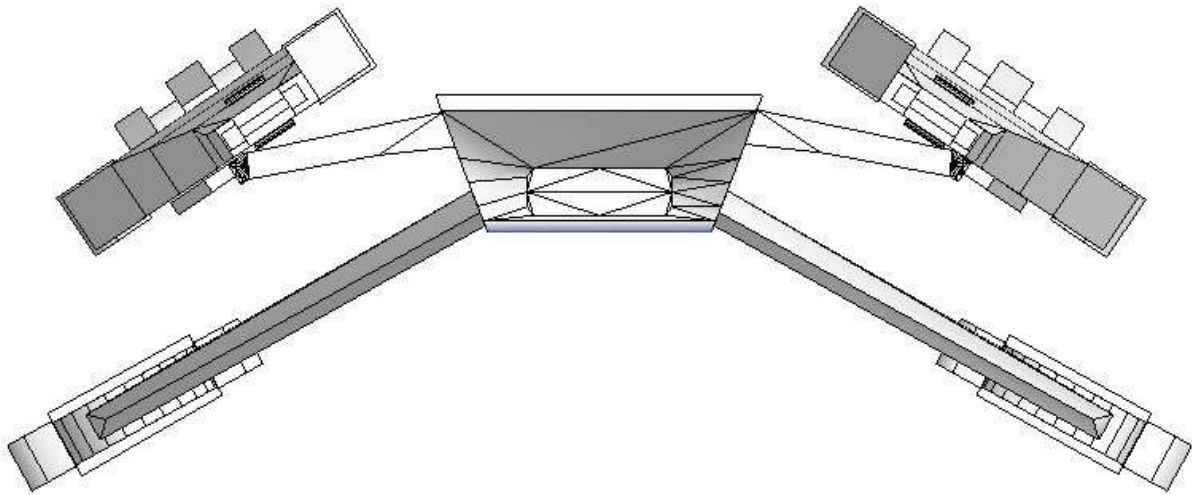

Enjoy your model, and please, send me a photo of your finished model.
I would really appreciate it!
stevebondy@shaw.ca